

# user's manual instrukcja obsługi

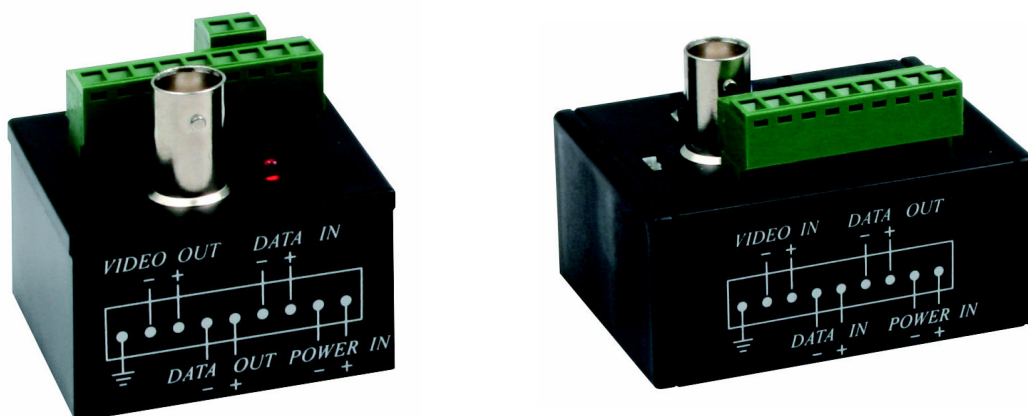

eng

pl

## NVPT-111AVDT

# NOVUS<sup>®</sup>



# user's manual

eng

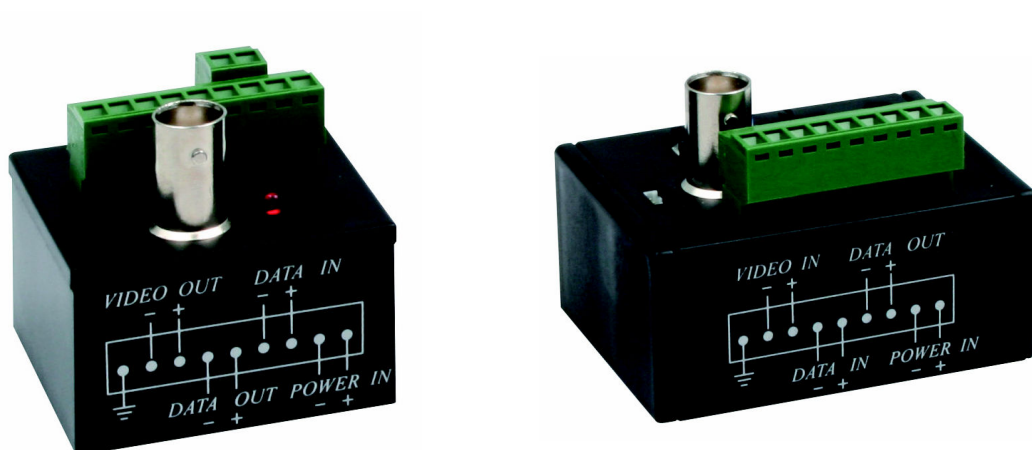

## NVPT-111AVDT

**noVus<sup>®</sup>**

## TABLE OF CONTENTS

---

---

### TABLE OF CONTENTS

1.	Main features and specifications.....	8
3.	Installation view.....	9
4.	Troubleshooting.....	10
5.	Notes.....	11

eng

## WARNINGS AND PRECAUTIONS

### EMC (89/336/EEC) and LVD (73/23/EEC ) Directives

#### CE Marking

 Our products are manufactured to comply with requirements of following directives and national regulations implementing the directives:

- Electromagnetic compatibility EMC 89/336/EEC with further amendments.
- Low voltage LVD 73/23/EEC with further amendment. The Directive applies to electrical equipment designed for use with a voltage rating of between 50VAC and 1000VAC as well as 75VDC and 1500VDC.

eng

### WEEE Directive 2002/96/EC



Information on Disposal for Users of Waste Electrical and Electronic Equipment

This appliance is marked according to the European Directive on Waste Electrical and Electronic Equipment (2002/96/EC) and further amendments. By ensuring this product is disposed of correctly, you will help to prevent potential negative consequences for the environment and human health, which could otherwise be caused by inappropriate waste handling of this product.

The symbol on the product, or the documents accompanying the product, indicates that this appliance may not be treated as household waste. It shall be handed over to the applicable collection point for the waste electrical and electronic equipment for recycling purpose.

For more information about recycling of this product, please contact your local authorities, your household waste disposal service or the shop where you purchased the product.



### RoHS Directive 2002/95/EC

Concerning for human health protection and friendly environment, we assure that our products falling under RoHS Directive regulations, regarding the restriction of the use of hazardous substances in electrical and electronic equipment, were designed and manufactured in compliance with mentioned regulation. Simultaneously, we claim that our products were tested and do not contain hazardous substances exceeding limits which could have negative impact on human health or natural environment.

#### Information

The device, as a part of professional CCTV system used for surveillance and control, is not designed for self installation in households by individuals without technical knowledge.

The manufacturer is not responsible for defects and damages resulted from improper or inconsistent with user's manual installation of the device in the system.

## WARNINGS AND PRECAUTIONS

---

---

### WARNING!

**READ, KEEP AND FOLLOW THESE INSTRUCTIONS. ALL THE SAFETY AND OPERATING INSTRUCTIONS SHOULD BE READ BEFORE THE PRODUCT IS OPERATED.**

eng

### WARNING:

TO REDUCE THE RISK OF FIRE OR ELECTRIC SHOCK DO NOT EXPOSE THIS UNIT TO RAIN OR MOISTURE IF THIS UNIT IS DESIGNED FOR INDOOR USE ONLY.

### WARNING!

USER IS NOT ALLOWED TO DISASSEMBLE THE CASING IF THERE ARE NO USER-SERVICEABLE PARTS INSIDE THIS UNIT. ONLY AUTHORIZED SERVICE PERSONNEL MAY OPEN THE UNIT INSTALLATION AND SERVICING SHOULD ONLY BE DONE BY QUALIFIED SERVICE PERSONNEL AND CONFORM TO ALL LOCAL REGULATIONS

### WARNING!

DEVICE IS SENSITIVE TO ELECTROSTATIC DISCHARGES THEREFORE IT SHOULD BE USED IN ACCORDANCE WITH OPERATING AND MAINTENANCE RULES FOR DEVICES BASED ON CMOS/MOSFET TECHNOLOGY.

## INFORMATION

Data included in the following user's manual is up to date at the time of printing. Novus Security Sp z o.o. holds exclusive rights to modify this manual. The producer reserves the rights for device specification modification and change in the design without prior notice.

## WARNINGS AND PRECAUTIONS

---

---

1. Installation and servicing of the converter should only be carried out by qualified service personnel and conform to all local regulations.
2. Do not place the converter in areas where ventilation openings might be blocked or covered.
3. There are no user-serviceable parts inside this unit. Only authorized service personnel may open the unit. The equipment should be protected from mechanical damage and kept clean at all times.
4. Protect this device from being exposed to dust and moisture. In the event of the converter coming into direct contact with water unplug the device immediately and contact qualified service personnel. Dusty (soiled/dirty) equipment may be the cause of fire and / or electrical shock.
5. Unplug the unit from the outlet before cleaning. This device can be cleaned only with a clean damp cloth. Try to avoid using chemically active liquid cleaners or aerosol. In the event of strong dirt it is allowed to use gentle cleaning lotion.
6. Power supply wires as well as signal wires should be fixed in the way that there is no risk of mechanical damage, Please take extra caution not to overload sockets and extension cords to prevent from the risk of fire.
7. In order to prevent the unit from damage, video channel and signal wires should be equipped with appropriate surge protection device conforming to European Union standards. We also advice utilizing video and data transmission protection.
8. It is not allowed to operate this device in conditions not complying with exploitation requirements in the range of power supply, relative air humidity or air temperature.
9. Metal objects cannot be put inside the device. It can cause major malfunction and/or damage the unit. In the event of the above, user should contact service immediately for further assistance.

eng

## MAIN FEATURES AND SPECIFICATIONS

### 1. Main features and specifications:

#### NVPT-111AVDT (transmitter NVPT-111AVDT + receiver NVPT-111AVDT)

- Transmit a full motion color or monochrome video signal and data signal (RS422, RS485). Color range 1500 meters, B/W video signal up to 2400 meters;
- Three position range switch for gain select on transmitter **NVPT-111AVDT**;
- 10 level (0-9) gain adjustment (color contrast) rotary switch on receiver **NVPT-111AVDT**;
- Built in transient protection and ground lifting, damaging voltage spike problems are eliminated;
- Red LED: Power on / off;
- Perfect for Speed dome camera use;
- Two power supplies included;

<b>Model</b>	<b>NVPT-111AVDT(T)</b>
<b>Video input</b>	1 V <sub>p-p</sub> , 75 Ohm (BNC)
<b>Power supply</b>	12 VDC
<b>Power consumption</b>	40 mA
<b>Dimensions (mm)</b>	43,2(W) x 43,2(H) x 41,7(L)

<b>Model</b>	<b>NVPT-111AVDT(R)</b>
<b>Video input</b>	1 V <sub>p-p</sub> , 75 Ohm (BNC)
<b>Power supply</b>	12 VDC
<b>Power consumption</b>	40 mA
<b>Amplification</b>	1 0~300M 2 300~600M 3 600~900M 4 900~1200M 5 1200~1500M
<b>Video cable recommended</b>	CAT 5 UTP (24AWG)
<b>Dimensions (mm)</b>	57,3(W) x 43,2(H) x 41,7(L)

PANEL AND INSTALLATION VIEW

2. Installation view

NVPT-111AVDT(T)

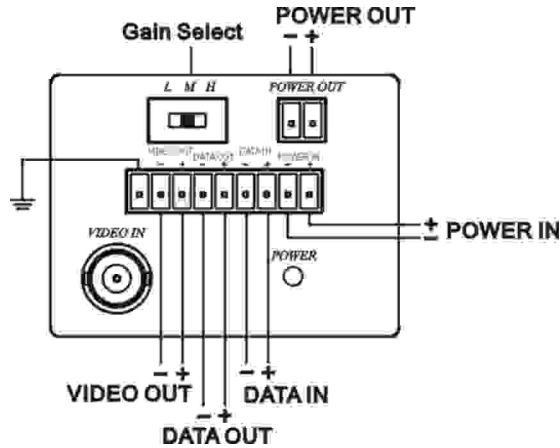

NVPT-111AVDT(R)

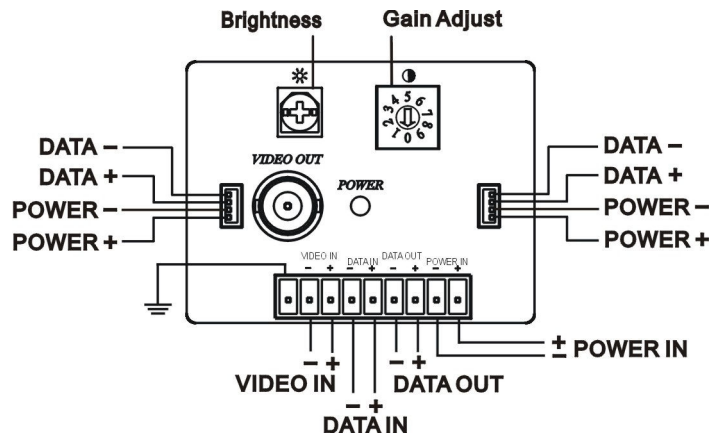

Installation view: NVPT-111AVDT

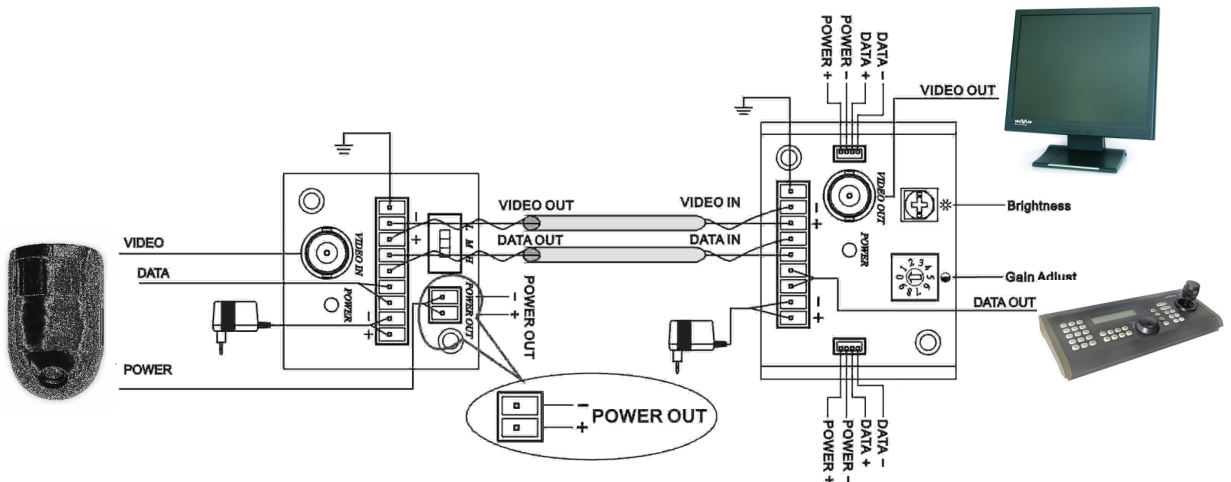

## PANEL AND INSTALLATION VIEW / TROUBLESHOOTING

NVPT-111AVDT(R) receiver case could be stackable. Up to 8pcs could be rack mounting at 19" rack.

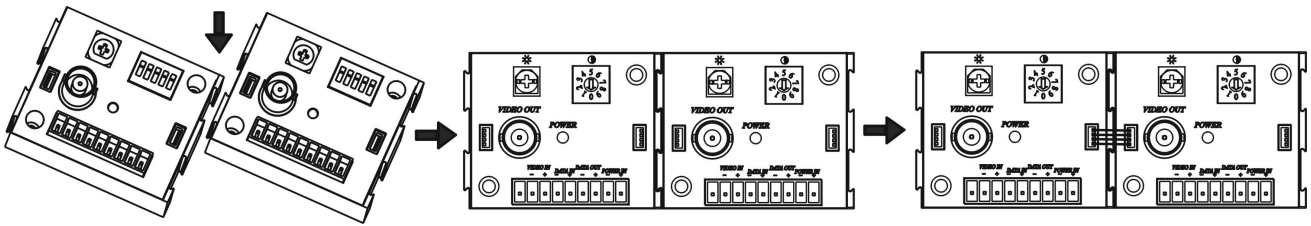

eng

### 3. Troubleshooting

All transmission distances mentioned above are without connecting image processor (e.g. quad, multiplexer, DVR), the transmission range would be reduced 100-200meters upon different camera, cable, DVR etc.

1. These products, with built in video amplifier function, are designed for long range transmission. If your transmission range is under 100 meters, the video gain function is too big and may result in snowy, wavy or bright image. It is recommended to use them with range at least over 100 meters or alternate passive video transceivers series for short range transmission.
2. The active receiver has 5 position distance range switch for different range transmission. Please switch to appropriate range upon your application to avoid any weak or bad image.

**3. Notes**

eng

**NOVUS<sup>®</sup>**

**NOVUS Security Sp. z o.o.**

ul. Puławska 431, 02-801 Warszawa  
tel.: (22) 546 0 700, fax: (22) 546 0 719  
[www.novuscctv.com](http://www.novuscctv.com)